



## NAZCA 07 User manual - English



Please read this user manual carefully before you use the NAZCA.

# Welcome to GIN Kiteboarding...

Thank you for choosing a GIN kite.

Our R&D team has invested a lot of time, passion and experience into creating the NAZCA.

We hope you will enjoy this kite as much as us, and we wish you many wonderful sessions with your new NAZCA !

For more information and to keep in touch with the fantastic evolution of our sport, visit our website :

[www.ginkites.com](http://www.ginkites.com)

Please pass on this manual to the new owner if you ever resell your kite.

Enjoy riding GIN,

The GIN Kiteboarding Team

## Information about safety

Aimed at customers with a good knowledge of kiting, this manual principally provides technical information about the NAZCA. This manual cannot replace training from an approved kite school.

Kiting is a magnificent sport, but certain rules do apply and these must never be neglected. As an "ambassador" of our sport, please respect these rules and always keep safety in mind :

Respect :

- the other riders
- the kite launch and landing zones
- the riding locations
- the rules of riding and of the air
- the public and their safety
- the natural elements

Familiarize yourself with :

- your equipment
- your safety equipment

Make sure that you have adequate personal and third party liability insurance for kiting.

The manufacturer as well as the distributors and agents of GIN Kiteboarding products cannot be held liable for death, personal injury or material damage resulting from any use of this equipment.

# Table of contents

<b>Welcome to GIN Kiteboarding .....</b>	<b>1</b>
<b>Information about safety .....</b>	<b>2</b>
<b>Table of contents .....</b>	<b>3</b>
<b>Gin Kiteboarding .....</b>	<b>4</b>
Construction .....	4
<b>History of the NAZCA.....</b>	<b>5</b>
<b>Characteristics of the NAZCA .....</b>	<b>6</b>
Description of a tube kite.....	7
Single point inflation system .....	8
Line deflectors .....	8
Handle on the leading edge.....	9
Safety handles .....	9
Advanced Performance (AP) 5th line bridle .....	10
<b>NAZCA control bar .....</b>	<b>11</b>
Description of the NAZCA's bar.....	11
Swivel system .....	12
Adjusters.....	12
Depower line .....	12
Streamer .....	13
Flying lines .....	13
Colours code : flying lines - pigtails .....	13
Adjustment of the bar.....	14
Lineplan of the NAZCA.....	15
<b>Safety system of the NAZCA.....</b>	<b>16</b>
Main quickrelease .....	16
Quickrelease of the 5th line .....	17
To connect a kite leash (for un-hooked riding) .....	18
To connect a "suicide leash" (for un-hooked riding without safety).....	18
<b>Windrange of the NAZCA.....</b>	<b>19</b>
<b>Technical data .....</b>	<b>20</b>
Flat surface area .....	20
Aspect ratio .....	20
<b>Accessories.....</b>	<b>20</b>
GIN pump .....	20
NAZCA bag .....	21
<b>Looking after your kite .....</b>	<b>22</b>
Control bar set-up and safety system .....	22
Warning.....	22
<b>GIN Kiteboarding warranty .....</b>	<b>23</b>
<b>Acknowledgements .....</b>	<b>24</b>

## Gin Kiteboarding

GIN Kiteboarding is a rider's company. For us kiteboarding stays a priority and a style of life. Our philosophy is to develop products of high quality that are able to provide us maximum satisfaction. We are stoked afterwards to share these sensations with all the users of our products, to be close to our customers and their needs.

The designer Robert Graham is proud to be working together with performing and passionate riders who all belong to the R&D team of GIN Kiteboarding.

Marc Ramseier and Robert Graham



## Construction

A highly skilled workforce take extreme care during the entire manufacturing process of our kites. Every piece of fabric, reinforcement and detail has been carefully designed, refined and crafted from the most suitable, selected materials. Everything is then assembled in a finely controlled process to create this kite.

After several hours of use, you will still discover small details that simplify your kiting life as a result of the thought GIN put into the design for you.

## History of the NAZCA

During a trip in Peru in 2005, Robert Gaham had the huge privilege to be authorized to fly over the NAZCA lines with a paraglider. Discovered in 1939, the NAZCA lines are composed with enormous geometrical lines and 18 drawings of animals engraved in the ground. Some lines and drawings even cross valleys and mountains. Some drawings are so big that they can only be seen from more than 300 metres above. Realized 2'000 years ago, the NAZCA lines continue to challenge historians and archaeologists from all over the world who have still not succeeded in uncovering their mystery. The Gin Kiteboarding Team was so impressed and charmed by these lines that we wanted to pay homage to them by calling our new hybrid kite : NAZCA. The bird printed on the wingtip of the kite is the condor drawn in the NAZCA lines.

GIN pilot flying over the condor of the NAZCA lines

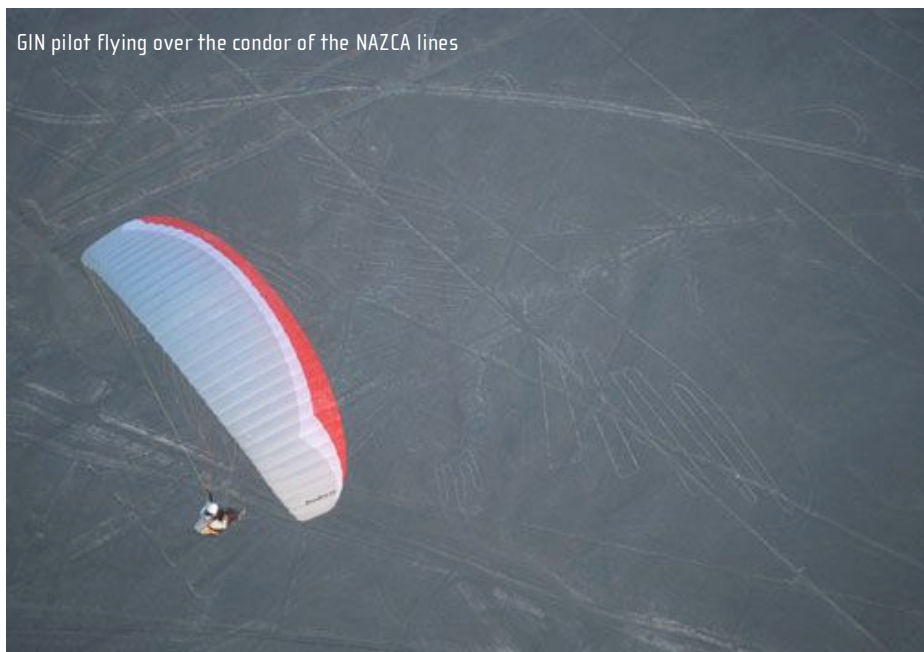

## Characteristics of the NAZCA

The NAZCA is a freeride and freestyle kite.

The concept behind the NAZCA hybrid kite has been to combine 100% safety with a harmonious balance between depower, performance and handling.

We have developed an innovative 5th line bridle system, which - in cooperation with other features - provides incredible low-end and turning performance, while the flat arc design contributes a great deal of depower.

All together the NAZCA has an excellent wind range and offers great versatility for all kinds of riders in any and all conditions.



The NAZCA strikes with incredible low-end performance, which means that you can basically take one size smaller than you would with a kite that mainly concentrates on depower.

The 5th line system enables easy relaunching from the water, easy riding away after releasing the safety, simple and secure launching and landing when you happen to be on your own.

The NAZCA also features a very nice progressive steering and doesn't require high bar pressures to fly and turn the kite. Whenever the bar pressure gets too high- simply pull the depower strap to bring it back in tune.

## Description of a tube kite

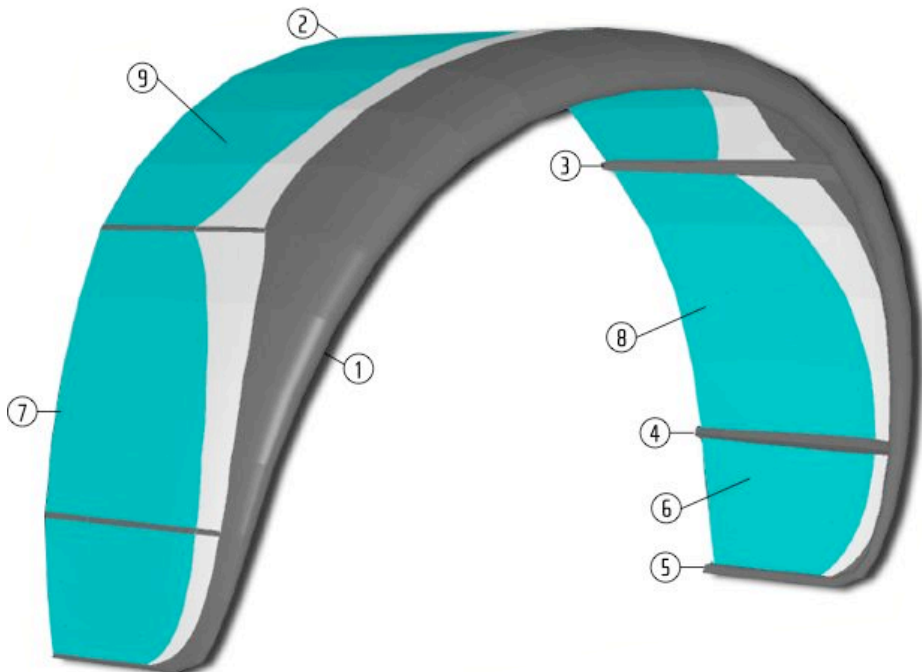

1. leading edge (LE)
2. BB0 (strut)
3. BB1 strut)
4. BB2 (strut)
5. BB3 (strut wingtip)
6. wingtip
7. trailing edge
8. bottom
9. top

## Single point inflation system

Pump up your kite from one point only – a much better warm-up, gets you out on the water quicker and adds a whole lot of simplicity to your session. You do have the choice of sealing off the connections between struts and LE. This helps in case of a puncture or to store the kite with struts inflated. In order to re-balance the pressure in the whole kite, open all the connections before inflating the LE.

Whenever you replace a bladder, throw away the 3 white plastic zip ties that all help to achieve an airtight connection between the valve and the tube (visible on pict 1). Change the bladder and use 3 new plastic zip ties. Cover the valves with the neoprene covers (pict 2).



## Line deflectors

We've framed the strut ends at the trailing edge with deflectors, which prevent any lines getting caught. The deflectors won't restrict the struts from their freedom of movement at the trailing edge, enabling a better airflow..





## Handle on the leading edge

The main leading edge tube is equipped with a double use handle :

- It enables you to attach the strap of the pump to it, in order to inflate the NAZCA without holding the kite.
- You will benefit from an easy and safe handhold to carry your NAZCA up-wind, inner surface facing up, top surface down.



## Safety handles

If you need to return to the beach in self-rescue, the 2 safety handles sewn on the wing tip struts will be convenient for controlling the NAZCA as well as possible.



## Advanced Performance (AP) 5<sup>th</sup> line bridle

We have developed a 5th line bridle with 5 LE attachment points that allow the kite to twist in the turns; introducing turning characteristics and performance that set new standards.

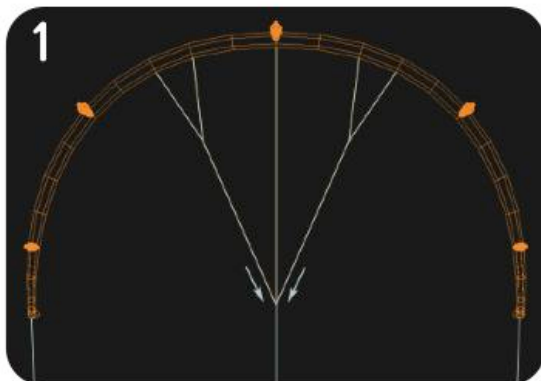

1. AP 5th line bridle when the kite is flying straight. There are no effects other than being a regular 5th line bridle that greatly supports the LE and its flat arc.

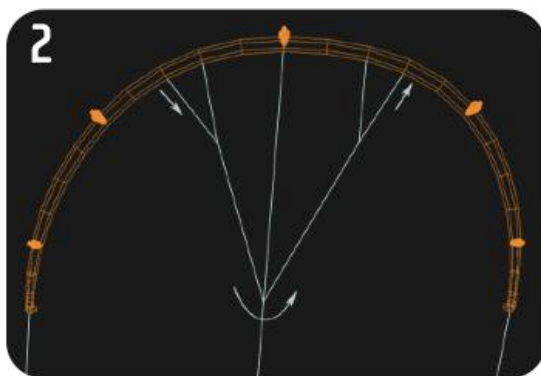

2. Behaviour of the AP 5th line bridle while the kite is being turned. We still have the same LE support, but the bridle allows the kite to modify its shape so that it can adjust to the aerodynamic properties of flying a curve. The deformation of the LE illustrated here is only the starting point that enables the kite to torque itself and to achieve different profiles along the LE.

# NAZCA control bar

## Description of the NAZCA bar



1. combined front line
2. left rear pre-line
3. right rear pre-line
4. streamer (trimming system)
5. 5<sup>th</sup> line
6. depower line
7. main safety system (sleeve)
8. swivel (swivel system)
9. chicken-loop
10. stoosh
11. quickrelease of the 5<sup>th</sup> line
12. elastic for holding wound lines
13. floater
14. rear line adjuster
15. carbon bar (47 / 56 cm)

## Swivel System

The swivel of the chicken-loop (swivel system) allows you to cancel any twists on the front flying lines and on the 5<sup>th</sup> line. To unwind the twists after a jump with one or more rotation(s), it is easy to turn the bar first to cancel the twist on the rear flying lines, then to pull down the bar. The act of pulling down the bar relieves pressure on the swivel and allows it to automatically rotate, cancelling any twists in the front lines and the 5<sup>th</sup> line.

## Adjusters

The adjusters of the rear pre-lines allow a quick and precise adjustment of the line lengths.

## Depower line

The depower line can be exchanged easily without tools. You just need to make the knot on the metal D-ring of the safety system as shown in the 7 pictures below. Then connect each end of the depower line with a bowline knot to the metal D-ring of the streamer (trimming system). The original depower line delivered with the bar is specially designed to resist wear but it should be inspected regularly.



## Streamer

For added safety, the streamer is reinforced with back-up webbing.

## Flying lines

The NAZCA is delivered with a set of 5 x 25m coloured flying lines.

### Colour code : flying lines - pigtails

A logical colour code is used to avoid any mistakes when connecting the lines :

Fronts : red lines – red pigtails

Right rear : blue line with black webbing – black pigtail

Left rear : blue line with blue webbing – blue pigtail

5<sup>th</sup> line : grey line with black webbing – black pigtail

To connect the 5<sup>th</sup> line, hold the bridle of the kite without any twist in its lines (pict 1). Then connect the 5<sup>th</sup> line to the knot of the black pigtail (arrow of pict 2).

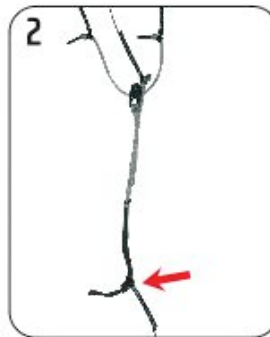

## Adjustment of the bar

The neutral position of the bar allows easy adjustment of the 5 lines. The streamer must be completely released and the bar must be pushed up, away from you. Then, hold the chicken-loop and hold all 5 lines under equal tension : the knots of the front and rear pre-lines must be at the same level. At the bar end, all 5 lines must end at the same level. We advise you to regularly check the set up of the 5 lines and bar.

Neutral position of the bar



# Lineplan of the NAZCA

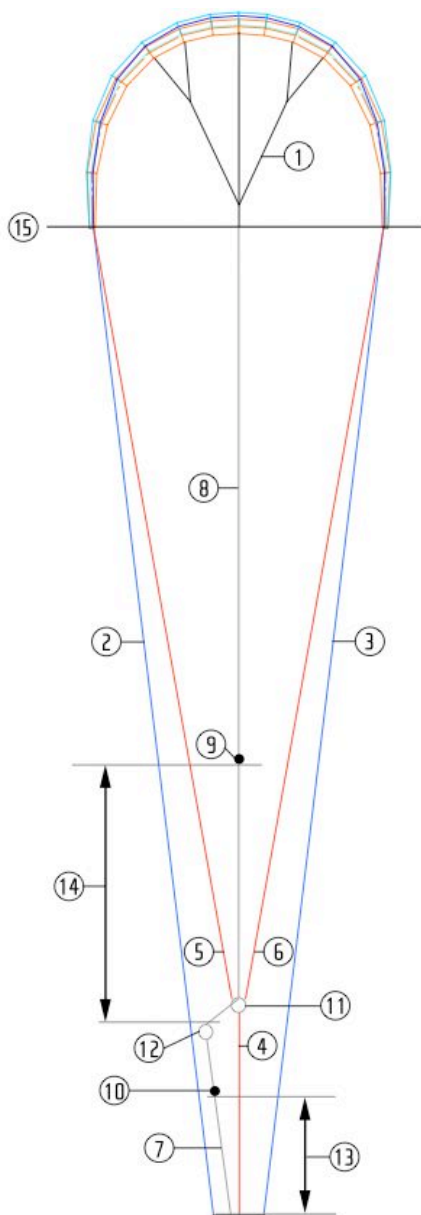

1. AP 5<sup>th</sup> line bridle
2. left rear flying line
3. right rear flying line
4. combined front line
5. left front flying line
6. right front flying line
7. 5<sup>th</sup> line – segment 1
8. 5<sup>th</sup> line – segment 2
9. plastic ball stopper on 5<sup>th</sup> line
10. plastic ball stopper on 5<sup>th</sup> line
11. metal ring on front lines
12. metal ring on 5<sup>th</sup> line
13. distance from the stopper ball to the end of segment 1 of the 5<sup>th</sup> line :

NAZCA 8.0 : 359 cm  
 NAZCA 10.0 : 402 cm  
 NAZCA 12.0 : 441 cm  
 NAZCA 14.0 : 447 cm

14. distance from the stopper ball to the end of segment 2 of the 5<sup>th</sup> line :

NAZCA 8.0 : 251 cm  
 NAZCA 10.0 : 281 cm  
 NAZCA 12.0 : 309 cm  
 NAZCA 14.0 : 334 cm

15. level zero of the 5 lines  
 (bar in neutral position )

## Safety system of the NAZCA

It is imperative that you know the correct operation and assembly of your safety system before using it. Always check your safety system before each use to make sure that it functions correctly.

### Main quickrelease

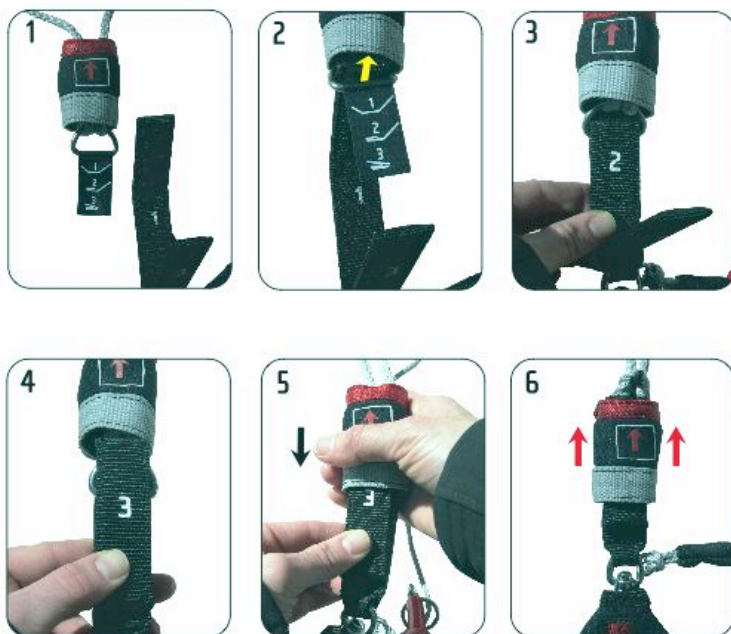

1. The sleeve of the main quick release is up around the depower line. The depower line is attached with a special knot (page 12) to the metal D- ring of the quick release system.
2. Pass the rigid webbing n°2 of the quickrelease through the metal D-ring, in the direction of the arrow on the picture.
3. Fold the webbing n°2 on the webbing n°1.
4. Cover the two layers of webbings (n°1 and 2) with the webbing n°3. Hold together the three layers of webbing(n°1, 2, 3).
5. Cover the three layers of webbing with the sleeve. Lock the quick release by pulling down the sleeve towards the swivel of the chicken loop.
6. To release : push the sleeve away from you, following the 2 arrows in the picture. You will still be connected to the kite by the 5<sup>th</sup> line.



## Quickrelease of the 5th line



1. Hold the free metal ring that slides along the 5<sup>th</sup> line.
2. Pass the pin through the free, sliding ring. Place the pin parallel to the grey line.
3. Slide the red plastic tube over the pin, right up to the free sliding ring.
4. To release : pull the red ball in the direction of the 2 arrows in the picture.

## To connect a kite leash (for un-hooked riding)

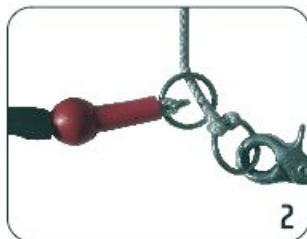

1. Hold the connector of your kite leash.
2. Connect the kite leash to the fixed metal 5<sup>th</sup> line ring. That's all ! No need to release the safety of the 5th line.

## To connect a "suicide leash" (for un-hooked riding without safety)



1. Hold the connector of your kite leash.
2. Connect the kite leash to the metal D-ring of the chicken-loop.
3. Ready to ride un-hooked with "suicide leash". This situation doesn't give you optimum safety : if you let go of the bar, you will still be connected to the kite, which will remain powered up.

## Windrange of the NAZCA

Size NAZCA (m")

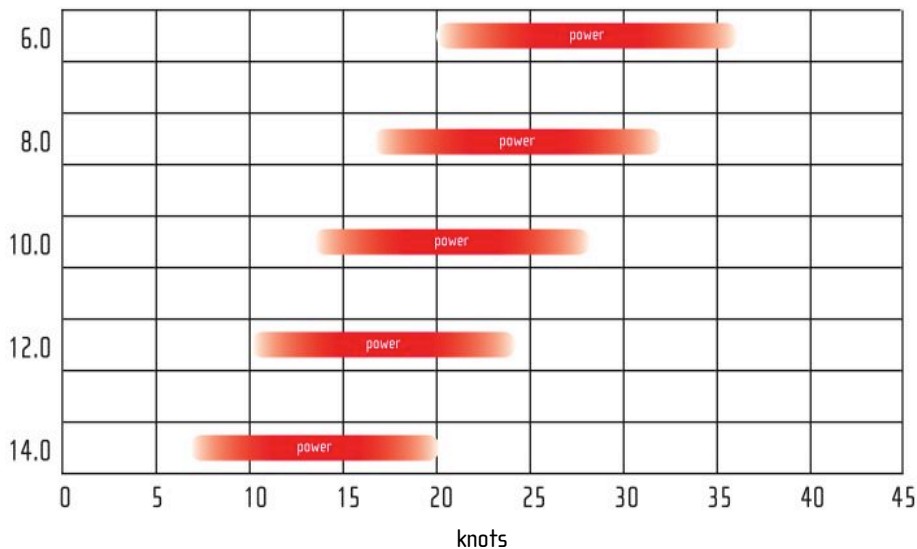

WARNING : This table should be used as an approximate guide only.

To make it accurate you would have to consider all variables that can modify the windrange, like :

- the weight of the rider
- the level of the rider
- the performance of the board
- the altitude and conditions specific to each location
- etc...

## Technical data

### Flat surface area :

NAZCA 8 : 8.0 m

NAZCA 10 : 10.05 m<sup>2</sup>

NAZCA 12 : 12.1 m<sup>2</sup>

NAZCA 14 : 14.15 m<sup>2</sup>

### Aspect ratio :

NAZCA 8 : 4.7

NAZCA 10 : 4.7

NAZCA 12 : 4.7

NAZCA 14 : 4.7

## Accessories

### GIN pump



- XL pump with Aluminium stem.
- Pump leash with quick-lock release to attach to the kite leading edge handle.

## NAZCA bag

NAZCA is delivered with 2 specially designed bags.



Main backpack :

- kite board straps and compression straps
- external pocket for the pump
- waist belt strap
- ventilation system and zip to allow the wing to dry to let water and sand out.
- the 2<sup>nd</sup> bag is in the internal lid pocket of the rucksack

2<sup>nd</sup> bag :

- designed to carry the NAZCA with inflated struts
- with the kite packed inside, it is possible to carry it either, across your shoulder, or to place it inside the main rucksack and to carry it on your back.
- kite size logo

## Looking after your kite

Do not leave your kite out in the sun or flapping in the wind if you are not using it, the cloth will prematurely age.

- Never store a wet kite for a long time. Make sure it is completely dry.
- Never use any sort of chemical cleaner on your kite. Only use normal water.
- Store your kite in a dark and dry place leaving the bag open.
- Do not walk on the lines or on the kite.

## Control bar set-up and safety system

- Check your control bar set-up and safety system before each use to make sure that it works correctly.
- Check for wear and tear on each part, also check all knots and lines, making sure that the neoprene protectors are in place where appropriate.
- Take care to clean your control bar set-up and your safety system of all sand, mud and dust.

## Warning

Your safety and the safety of others depend upon the correct use of this equipment. You are solely responsible for ensuring that you only use this equipment in situations and conditions suitable for your level of competence and in a way that will not endanger third parties.

- Safety does not only depend on the safety systems of the kite, it is also the result of training and of the correct evaluation of the situation and all conditions; the location, potential hazards, other people, the weather, etc
- It is extremely important to receive proper training before using this product and to fully familiarise yourself with all emergency procedures in safe conditions, before having to resort to them in an emergency. The safest place to obtain the necessary skills is from a suitably qualified and competent kite instructor or school. Do not attempt to fly this kite without the necessary skills.
- Your kite and safety systems must be regularly checked and properly maintained.
- NAZCA is a kite adapted for kitesurfing. Unlike a paraglider or a speedflying wing, the NAZCA is NOT designed for free flight and does NOT meet the specific safety requirements of free flight.

## GIN Kiteboarding warranty

GIN Kiteboarding warrants your NAZCA to be free of major defects in material or workmanship to the original purchase for a period of ninety days from the date of purchase. We invite you to register your NAZCA on the website [www.ginkites.com](http://www.ginkites.com) during the seven days after your purchase. We ask you to keep your original receipt.

This warranty is available under the following conditions :

- The warranty is valid only when the product was registered by the owner at [www.ginkites.com](http://www.ginkites.com) within seven days of the date of purchase.
- The warranty is valid only when this product is used for normal recreational activities, and does not cover products used in rental or teaching operations.
- GIN Kiteboarding will make the final warranty determination, which may require inspection and/or photos of the product, which clearly shows the defects. This information must be sent to the GIN Kiteboarding distributor in your country, postage prepaid. Products can be returned only after having received the authorization of GIN Kiteboarding.
- If Gin Kiteboarding declares that warranty is valid, the warranty will cover only the repair or replacement of the defective product. GIN Kiteboarding will not be responsible for any costs, losses or damages incurred due to shipment.
- The warranty does not cover damages caused by misuse abuse, neglect or normal wear and tear - including but not limited to – punctures and rigging with other than GIN Kiteboarding components. All damages due to : excessive sun exposure / over inflation of the bladders / improper handling and storage / use in waves or shore break will not be covered by the warranty.
- The warranty is not valid where any unauthorized repair, change or modification has been made to any part of the equipment.
- The warranty for any repair or replacement equipment is valid from the date of the original purchase only.
- The original purchase receipt must accompany all warranty claims. The name of the retailer and date of purchase must be clearly legible.
- There is no special, extra warranty except those laid out on this page.

## Acknowledgements

GIN Kiteboarding would like to thank the riders who contributed to the development of the NAZCA. Their effectiveness, their optimism and their ideas brought much to the result that is the NAZCA.

Thank you also to all the impassioned people who have given their energy and time for the NAZCA.

